



BUILDING DEPARTMENT

27700 Hilliard Blvd.
Westlake, OH 44145

Phone 440.617.4105
Fax 440.617.4144

RESIDENTIAL DECK SUBMITTAL CHECKLIST

Address _____

Owner _____

Contractor _____

Contact Name _____

Contact Email _____

Completed Deck Application / Indicate if Corner Lot	
2 Sets of Construction Plan drawings	
2 Copies of Topo or Site Plan indicating distances to all property lines, exact location and dimensions of proposed deck and steps	
Letter of approval from Condominium Association (If applicable)	
Construction Plans Should Include:	
All deck dimensions, post & beam layout, and house wall cantilevers (Down-view)	
Height of deck above grade	
Beam size and spacing	
Post size and spacing	
Joist size and spacing	
Beam connection to posts	
Joist connections to ledger and beam	
Ledger attachment to house and flashing	
Footing size, depth and method	
Floor framing plan indicating framing member sizes and spacing	
Connections of all structural members	
Size and type of decking material (pressure treated wood, vinyl, etc.)	
Height, size, type and spacing of guardrail posts and balusters	
Stair Tread (Width) and Riser Details (Height) of Steps	
Test to determine if plans are complete:	
Could someone else build your deck from the plans you are submitting?	
REQUIRED INSPECTIONS / SCHEDULED 24 HOURS IN ADVANCE:	
Footer (Post Holes) <i>before</i> posts are in place and concrete is poured	
Frame prior to installing flooring and railings	
Final when Deck is completed	

TYPICAL DECK SITE PLAN

PROVIDE THE FOLLOWING:

- *LOT DEMENSIONS (LENGTH AND WIDTH)
- *PROPOSED SIDE AND REAR (OR FRONT) YARD SETBACKS
- *DECK DIMENSIONS
- *STATE IF CORNER LOT – RESTRICTIONS APPLY

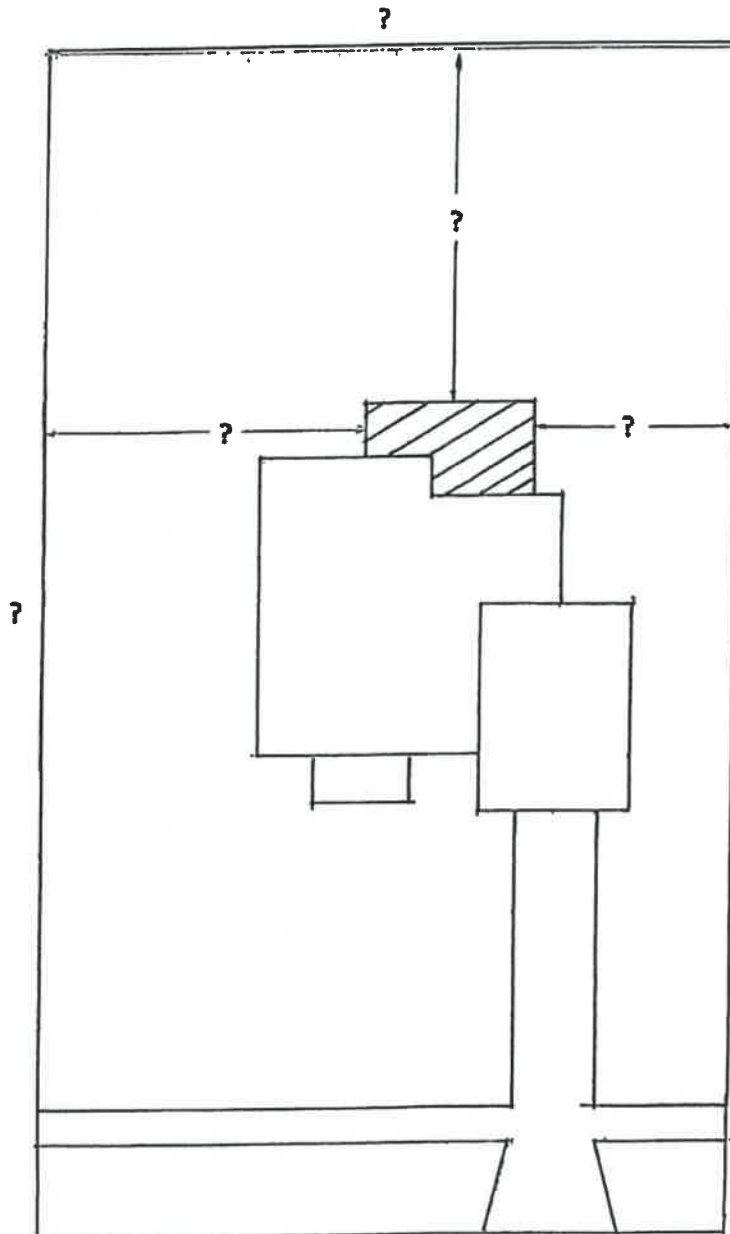

Residential Wood Deck Construction

Based on 2019 Residential Code of Ohio

This sheet provides some applicable building code information for deck construction, but does not cover unique or non-typical conditions which may create unusual design requirements (i.e. loading in excess of 50 PSF, unusual site conditions, etc.). When these situations are encountered **a licensed architect or engineer may be required for your design. Examples of some of these situations include:**

- *Decks serving more than a one and two family dwelling**
- *Decks including more than one level or roofs**
- *Decks supporting hot tubs, spas, or other objects**
- *Decks greater than 10' above grade**
- *Deck ledgers attached to overhangs, bay windows, brick, stone or concrete block**
- *Decks on slopes greater than 2 horizontal to 1 vertical.**

The following code sections from the Residential Code of Ohio should be used when designing and building your deck:

Section 507.3 Deck Footings
Section 317 Protection of wood & wood products against decay
Section 507 Exterior Decks
Sections 311 & 312 Stair, landings, handrails, and guards.

- *Decks shall be designed for 50 PSF uniform loading and shall be built of material which is pressure treated or naturally resistant to decay. Posts and applicable 2 x material shall be ground-contact treated wood.**
- *Fasteners, hangers, nails, etc., must be stainless steel, hot-dipped galvanized, silicon bronze or copper (see RCO for additional information).**
- *Ledger Board attachment shall be per charts located in section 502 or per manufacturer's installation specifications.**

As an alternate to designing a deck prescriptively per the Residential Code of Ohio, one may use the DCA-6 Prescriptive Residential Deck Construction Guide (by the American Wood council) or an engineered design.

See attachments detailing submission requirements for applications and plans

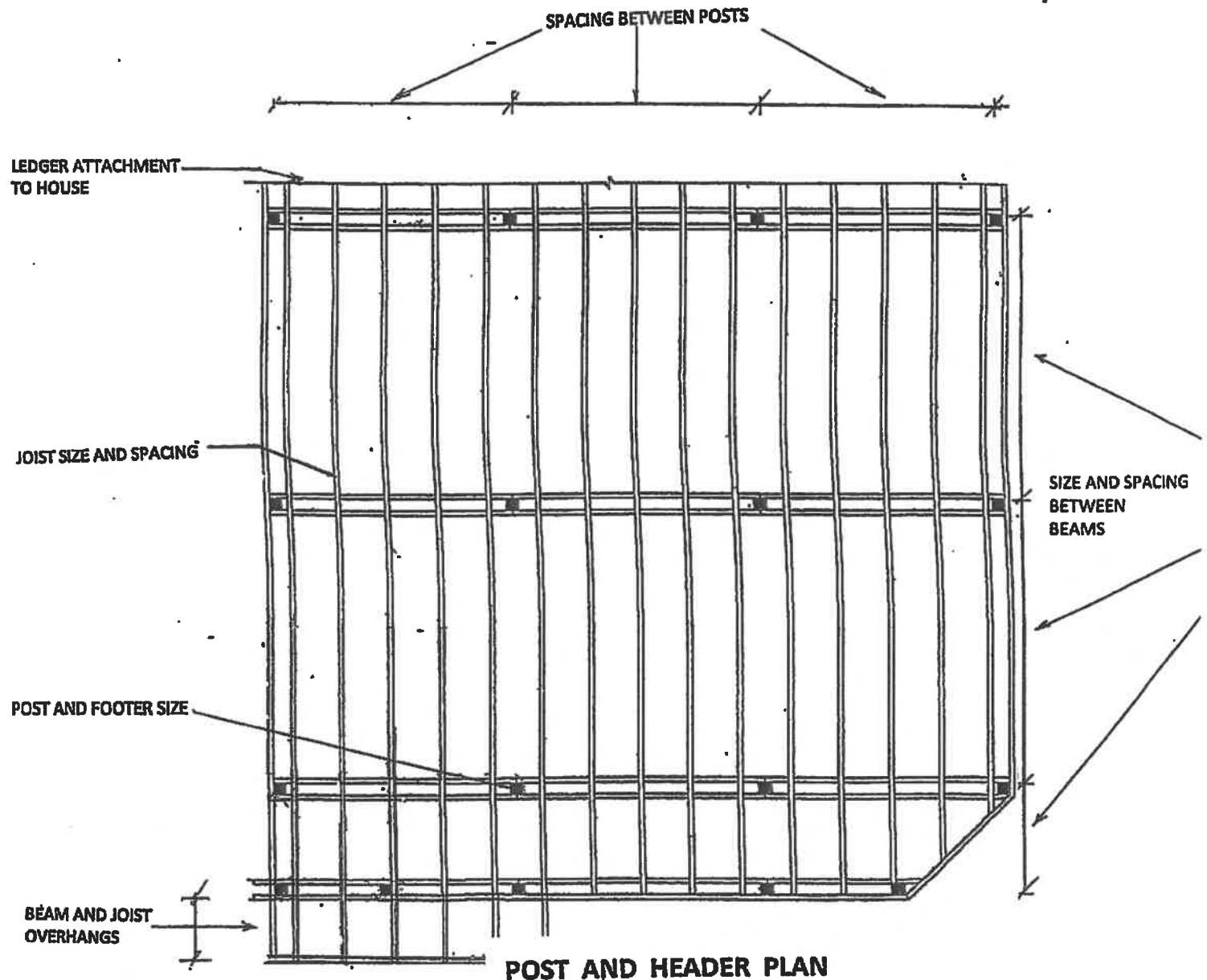

ITEMS REQUIRED ON DRAWINGS

TYPICAL DECK SECTION

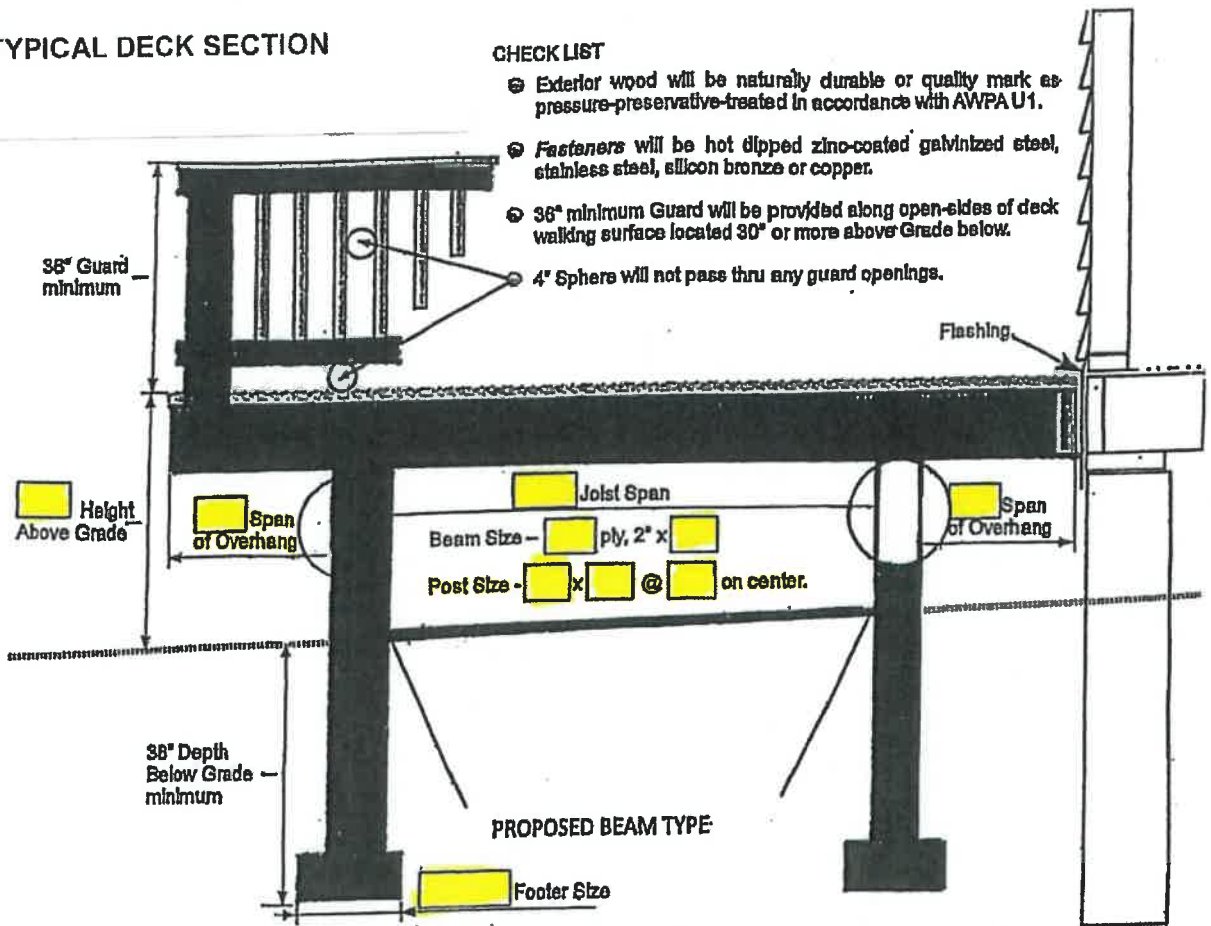

Beam to Post Connection Options

Choose one beam to post connection option. Choose one post size based on the height of the deck.

